

# TA PISTON AIR PUMPS

1/6, 1/4 AND 1/3 HORSEPOWER 12 VOLT DC

*Cust specific*

## MAINTENANCE-INSTALLATION INSTRUCTIONS

### GENERAL

Operation and maintenance instructions as well as parts information presented herein relate to the following motor mounted, piston air compressor model:

- TA-2101 - DC (1/6 Horsepower)
- TA-3101 - DC (1/4 Horsepower)
- TA-4101 - DC (1/3 Horsepower)

### OPERATION

**AMBIENT CONDITIONS:** Pumps should be operated in a well ventilated area where the surrounding air is relatively clean, dry and temperatures are consistently within the range of 35°F to 95°F.

#### ELECTRICAL:

Unit must be wired in accordance with local electrical codes. Unit must be protected by a separate over-current protector (fuse) located in the positive (+) lead wire from power source. Wire size to be minimum 8 gauge. Fuse should be based upon 115% of full motor load.

#### MOTOR:

Electrical connections must be made using ring type connectors. All connections must be electrically, mechanically, and galvanically sound to withstand vibration and movement encountered in normal service.

**FILTERS:** Do not operate pumps without an inlet air filter. Excessive dirt, foreign particles, moisture, or liquids entering the pump can contribute to poor performance and/or premature failure. Dirty filters reduce pump performance by

### **WARNING**

AS WITH ANY ELECTRICAL DEVICE THAT USES A BATTERY FOR A POWER SOURCE, AN ELECTRICAL SPARK MAY OCCUR WHEN CONNECTING MOTOR/COMPRESSOR. **DO NOT DISCONNECT MOTOR/COMPRESSOR OR BATTERY WHILE IN THE PRESENCE OF ANY FLAMMABLE LIQUID OR ATMOSPHERE.**

restricting air flow. Inspect filter elements periodically and clean or replace when necessary. **DO NOT CLEAN FILTER ELEMENTS WITH PETROLEUM BASED PRODUCTS.**

**WARNING—These Products are suitable for pumping only atmospheric air. As defined in Compressed Gas Association Pamphlet G-7, Page 3, atmospheric air is a mixture of elements and compounds where nitrogen and oxygen comprise more than 99% with all other trace gases comprising less than 1%. DO NOT USE THIS PRODUCT IN CONTAMINATED ENVIRONMENTS OR FOR PUMPING MIXTURES OTHER THAN ATMOSPHERIC AIR.**

### **WARNING**

RIETSCHLE THOMAS OFFERS OIL-LESS AIR COMPRESSORS WHICH PROVIDE CLEAN, OIL-LESS DISCHARGE AIR. HOWEVER, OSHA SPECIFICATIONS REQUIRE ALL BREATHING AIR SYSTEMS TO MEET THE STANDARDS AS SPECIFIED FOR "TYPE 1, GROUP D AIR," AS FURTHER DEFINED IN CGA PAMPHLET G-7. **THEREFORE, ALL COMPRESSED AIR BREATHING SYSTEMS MUST INCLUDE AIR FILTRATION EQUIPMENT FROM COMPRESSOR INTAKE TO FINAL RESPIRATOR DEVICE.**

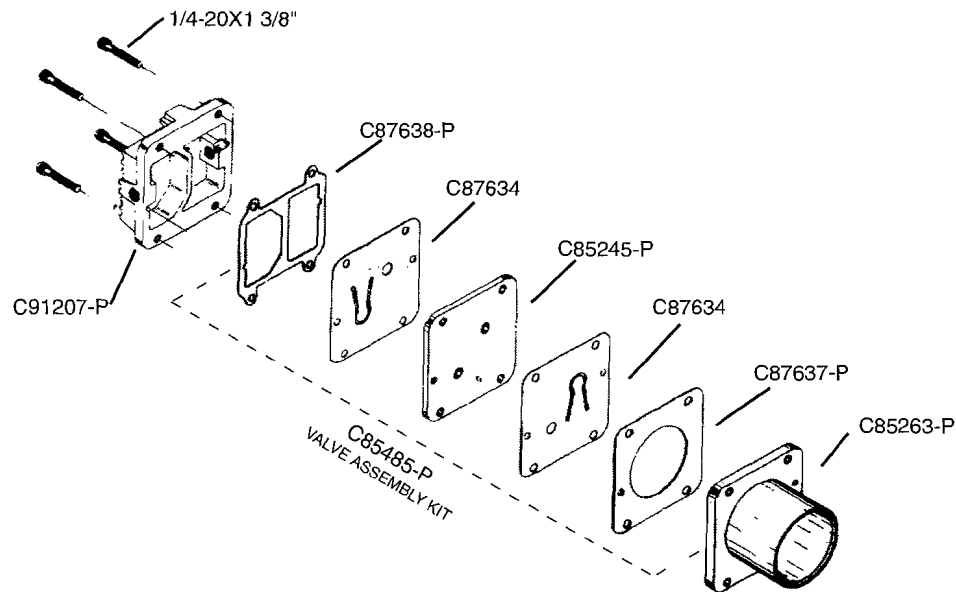
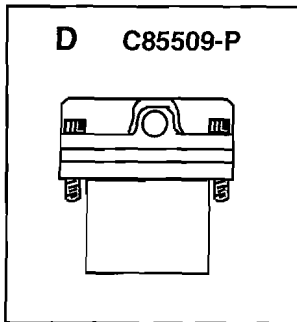

**TA-2101-DC, TA-3101-DC, TA-4101-DC**

**C85493-P Minor Service Kits** (Includes C85485-P Valve Assembly Kit and C87860-P Ring Service Kit) – replace at 6000 hours continuous duty/maximum pressure (33% duty cycle ≈ 2+ years).

**Major Repair Kit** (Includes C85493-P Minor Kit and Piston Rod Assembly. Kit Part Number on Front) – replace at 12000 hours continuous duty/maximum pressure.

**C85517-P Brush Kit** – Replace at 1000 - 2000 hours.

# TA-2101-DC, TA-3101-DC, TA-4101-DC

## PARTS LIST

NOTE: Teflon Tape is not recommended when installing intake filters.

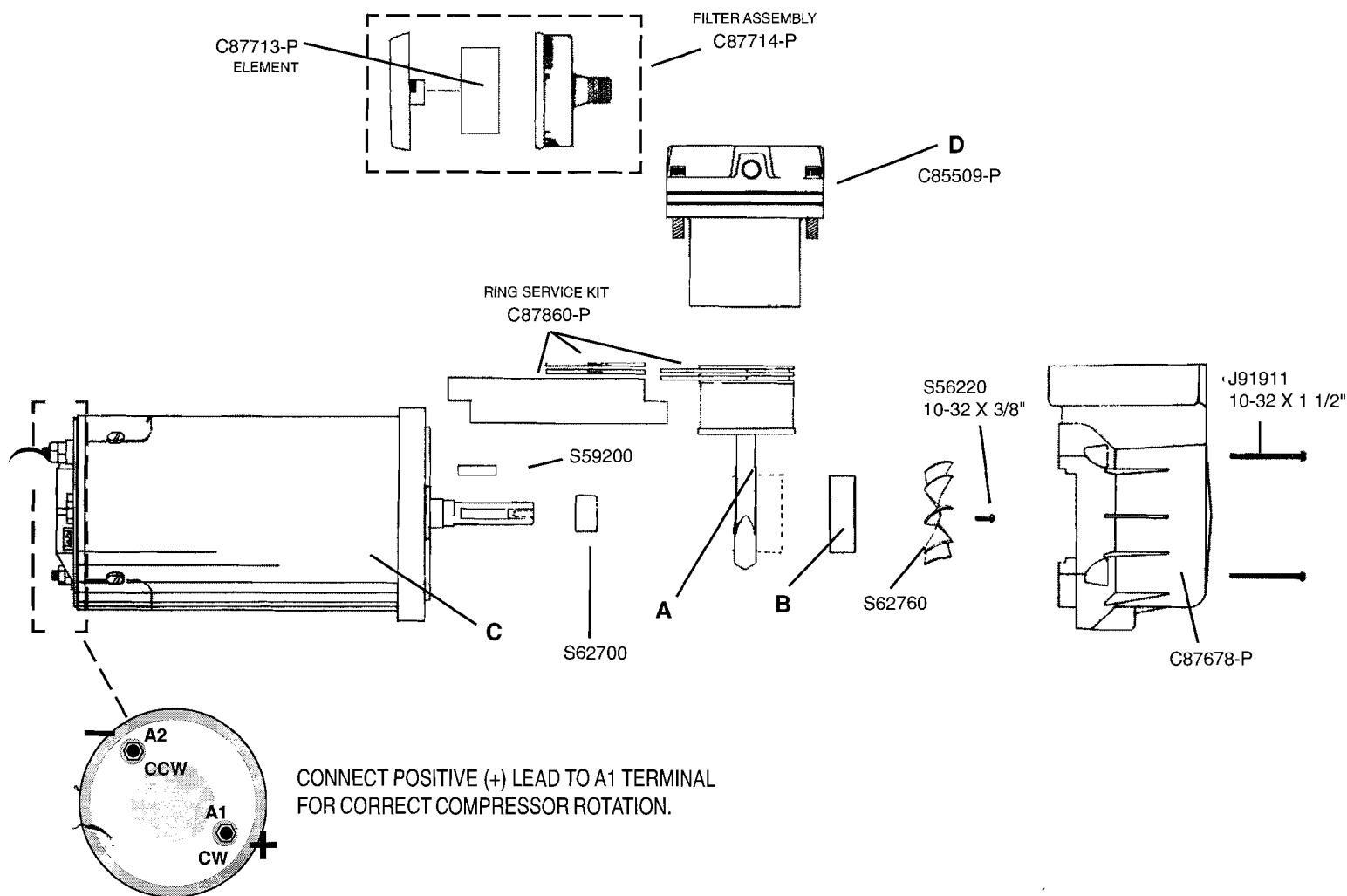

DO NOT DIRECT MOUNT UNIT TO EXISTING SYSTEM WITHOUT VIBRATION ISOLATORS

		A	B	C	MAJOR REPAIR KIT
TA-2101-DC	1/6	C87833-P	-----	M97073	C87861-P
TA-3101-DC	1/4	C87050-P	S60820	M97053	C87876-P
TA-4101-DC	1/3	C87048-P	C87326	M97054 12V	C87865-P
TA-4101-DC	1/3	C87048-P	C87326	M97075 24V	C85865-P

# MAINTENANCE

Only a few basic maintenance details are required to insure trouble free operation.

## FILTRATION:

Dirty Filters reduce pump performance. Periodically check inlet air filter. To clean filter, disassemble filter housing and use compressed air to blow dirt particles from the filter element. Replace filter when element can no longer be cleaned with this method.

## LUBRICATION:

The Taskair line of piston products is a dry, oil-less compressor/pump design. This product uses sealed grease-packed bearings and does not require additional lubrication.

## CAUTION:

**DO NOT LUBRICATE.** Adding greases or petroleum

**products to this unit will reduce performance and can potentially damage the product.**

## SERVICE KIT

Rietschle Thomas has available from stock minor service kits for Taskair series motor compressors. To obtain these service kits please contact the factory for the Taskair representative nearest you.

C85493-P minor service kit includes: Piston rings, springs, skirt, cylinder head gasket, and (2) valve reeds.

NOTE: For complete compressor rebuild, order (1) one minor service kit plus appropriate piston/rod assemble. (See Chart on Page 2)

## WARRANTY

A. Rietschle Thomas products, when properly installed and under normal conditions of use, are warranted by Rietschle Thomas to be free from defects in material and workmanship at time of shipment. Warranty claims regarding products must be asserted within 18 months (the "warranty period") from date of manufacture encoded on the product or 12 months from the OEM Product manufacture, whichever occurs first (unless otherwise agreed in writing or specified in a Rietschle Thomas Quotation).

The customer's exclusive remedy against Rietschle Thomas, for a warranty claim or otherwise, shall be limited to repair or replacement of the subject product if it is shown to have been defective in material and workmanship at the time of shipment, and then only if the claim is asserted during the warranty period. Rietschle Thomas's maximum liability under this exclusive remedy shall never exceed the cost of the subject product and Rietschle Thomas reserves the right, at its outside sole discretion, to refund the purchase price in lieu of repair or replacement, except for such warranty and exclusive remedy as stated (and except for the express warranty of title).

Rietschle Thomas DISCLAIMS ALL OTHER WARRANTIES WITH RESPECT TO ITS PRODUCTS, WHETHER EXPRESS OR IMPLIED, AND SPECIFICALLY DISCLAIMS UNDER THE IMPLIED WARRANTIES OF MERCHANTABILITY AND FITNESS FOR A PARTICULAR PURPOSE. IN NO EVENT SHALL RIETSCHLE THOMAS BE LIABLE TO CUSTOMER OR THIRD PARTIES IN WARRANTY, CONTRACT, NEGLIGENCE, STRICT LIABILITY, OR OTHERWISE, FOR ANY DAMAGES, WHETHER INCIDENTAL OR CONSEQUENTIAL, WHICH ARE ALLEGED TO HAVE BEEN CAUSED BY ONE OR MORE OF OUR PRODUCTS, BEYOND THE COST TO THE CUSTOMER OF THE SUBJECT PRODUCT OR PRODUCTS, THE EXCLUSIVE REMEDY FOR ANY CLAIM

HAVING BEEN LIMITED TO REPAIR OR REPLACEMENT AS AFORESAID.

B. Because Rietschle Thomas's warranties and remedies extend to our direct customers, the customer is not authorized to extend warranties on our behalf to anyone. Unauthorized extensions of warranties by the customer shall remain customer's responsibility.

C. CUSTOMER IS RESPONSIBLE FOR DETERMINING THE SUITABILITY OF OUR PRODUCTS FOR CUSTOMERS USE OR RE-SALE, OR FOR INCORPORATING THEM INTO OBJECTS OR FOR APPLICATIONS WHICH CUSTOMER DESIGNS, ASSEMBLES, CONSTRUCTS OR MANUFACTURES.

## D. RETURNS POLICY

All sales are final. However, in some cases returns may be allowed. No products will be accepted for return WITHOUT OUR WRITTEN APPROVAL AND UNLESS ACCOMPANIED BY A PROPERLY AUTHORIZED "Authorization to Return Goods" (ARG) initiated by Rietschle Thomas. Return freight must be PREPAID. For non-special or non-custom products accepted for return, transportation (if not prepaid) and a minimum restocking charge of 15% of the invoice value will be charged. Returned goods should be labeled as follows:

Example: ARG. 0000  
Rietschle Thomas Monroe, Inc.  
4601 Central Avenue  
Monroe, LA 71203

Special or Custom made products, including units that are modified from standard units, cannot be returned for credit.

Service parts cannot be returned for credit.



## Sales

1419 Illinois Avenue  
Sheboygan, WI 53082  
920-457-4891

## Shipping

4601 Central Avenue  
Monroe, LA 71203  
318-387-4280